





ACOMETIDA A/A					
VOLTAJES	CAPACIDAD	Consumo	CALIBRE	BREAKER	KW
240 VAC	12000 BTU	6 Amp.	12AWG	20 AMP	1.4
	18000 BTU	9 Amp.	10 AWG	30 AMP	2.1
	24000 BTU	12 Amp.	10 AWG	30 AMP	2.8
	36000 BTU	17 Amp.	8 AWG	50 AMP	4.0
	48000 BTU	24 Amp.	8 AWG	50 AMP	5.8
	60000 BTU	30 Amp.	8 AWG	50 AMP	7.2

SIMBOLO	DESCRIPCION
	CONSOLA A/A TIPO CASSETTE
	COMPRESOR DE A/A
	EXTRACTOR 12"X12" 120VAC
	FAN COIL A/A
	CONSOLA DE A/A TIPO SLIP

NOTAS:  
 -BASE EN HIERRO  
 -50 PIES DE TUBERIA 5/8  
 -50 PIES TUBERIA 3/8  
 -10 TIRAS DE VACOCEL 3/4  
 - 75 PIES COBLE 1/4  
 -2 FILTROS DE LINEA

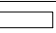

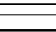
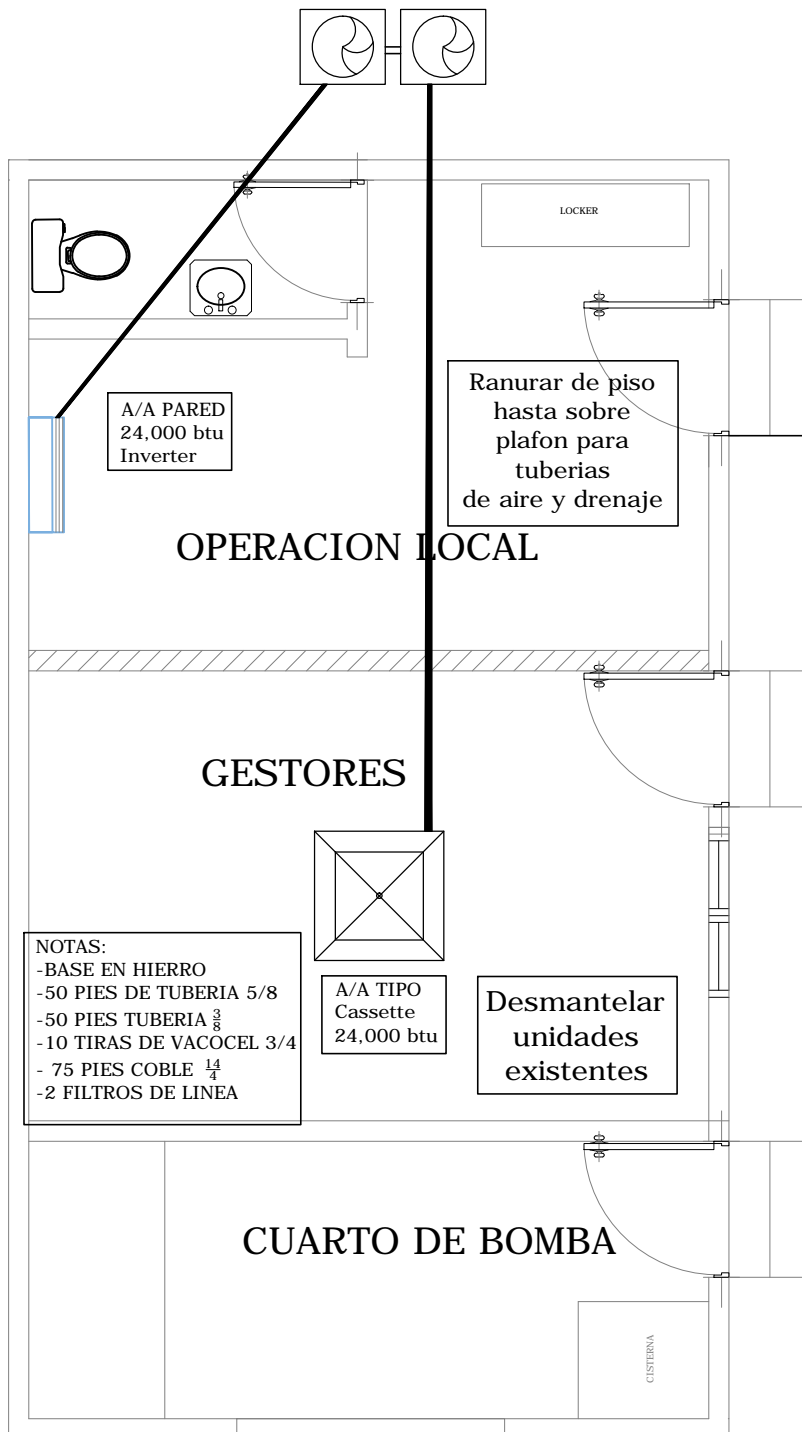
## OPERACION LOCAL 2130 PLANTA AIRES ACONDICIONADOS

**PROYECTO:** OPERACION LOCAL 2130

**UBICACION:** Sector SANTIAGO

**DISEÑO Y PLANIFICACION:** GSSGG

**PLANTA AIRES ACONDICIONADOS**

**NO. DE PLANO:**  
OPERACION LOCAL 2130

**ESCALA:** N/A

**P.12**

